

**LAKE COUNTY ENVIRONMENTAL HEALTH**

106 FOURTH AVENUE EAST

POLSON, MT 59860-2175

PH: 406-883-7236 FAX: 406-883-7205

Email: envhealth@lakemt.gov

**WASTEWATER TREATMENT SYSTEM FINAL INSPECTION & USE PERMIT**

Lake County Environmental Health (LCEH) hereby approves the Wastewater Use Permit # 8575 for the following:

**OWNER:** John + Lisa Parks / Deyo Family Trust

**MAILING ADDRESS:** 1 Aberdeen Road

**CITY:** Weston **STATE:** MT **ZIP:** 02493-1737

**LEGAL DESCRIPTION:** SECTION 22, T 23 N, R 19 W

**SUBDIVISION/COS:** Osher Tracts **LOT/TRACT#:** 4

**GEOCODE:** 15-3351-22-1-02-04-0000 **PARCEL SIZE:** 1.29 acres

**PHYSICAL ADDRESS:** 31611 Holmes Creek lane

**SYSTEM DESIGN:** TYPE: standard

**COMMUNITY SYSTEM:** YES  NO  **GPD:** 300 **BEDROOMS:** 3

**DRAINFIELD LAYOUT:** elevated sand mound **PUMP:** 410 Ashland

**SQUIRT HEIGHT:** 8' **SEPTIC TANK:** 1500 gallon w/ pump chamber

**SEPTIC TANK:** GPS-NS 397098.02 / GPS-EW 261191.36

**DF MANIFOLD:** GPS-NS 397099.2 / GPS-EW 261180.61

**WELL:** Holmes Creek/spring GPS-NS \_\_\_\_\_ / GPS-EW \_\_\_\_\_

**INSTALLER SIGNATURE:** David Jensen **DATE:** 7-5-18

**PRINTED NAME:** David Jensen - Jensen backhoe

I hereby certify the above system was installed in accordance with all applicable regulations and specifications.

**DESIGNER SIGNATURE:** Jim Todd **DATE:** 7-5-18

I, or a representative, hereby certify the above system was installed by design and in accordance with all applicable regulations and specifications. An As-Built design will be provided within 30 days of installation per SECTION 3.6 (1) of the Lake County Wastewater Treatment System Regulations.

**LCEH SIGNATURE:** Maria K. Luke, P.S. **DATE:** July 5, 2018

It is the property owner's responsibility to ensure the system is properly maintained and functioning within the guidelines set forth in the Lake County Wastewater Treatment System Regulations and the Montana Circular DEQ 4.

Any alteration of the wastewater treatment system not approved by Lake County Environmental Health Department invalidates this Use Permit. Any change in wastewater flow or strength from the design of this wastewater treatment system requires a Change of Use permit be issued. Examples include, but are not limited to: addition of a bedroom(s), altering a residential use, altering commercial or industrial use, replacement of structures, addition of a water treatment unit or a water fixture.

Minor repairs to the system will be allowed without an additional permit. These repairs are limited to: replacing a broken sewer line, pumping the septic tank (recommended every 3-5 years), cleaning the effluent filter (recommended annually) and replacing the effluent pump with a pump of equal specifications. Any other repairs require an approved Installation Permit from Lake County Environmental Health Department.

For more information please contact the Lake County Environmental Health Department.

**See attached As-Built for design specifications.**

# Todd Environmental Consulting, LLC

104 Orchard Park Lane  
Polson, Montana 59860

Phone: 406-314-1888  
Email: jilltodd@centurytel.net

July 5, 2018

Lake County Environmental Health  
106 Fourth Avenue East  
Polson, MT 59860-2175

RE: As-Built for Septic System, 31611 Holmes Creek Lane: Lot 4 Osher Tracts

Lake County Environmental Health:

Enclosed is the As-Built Drawing for the septic system installed at the above described property. The system was installed by Jensen Excavating and inspected by TEC and Lake County Environmental Health on July 5, 2018. The system consists of a 1,500 gallon septic tank/pump chamber and an elevated sand mound absorption system with a 10'+ by 40'+ gravel bed. A 4/10 HP Ashland effluent pump was utilized. The squirt height from the laterals was approximately 8 ft. in height.

The 4" Sch. 40 sewer line from the house to the tank had not been installed yet at the time of inspection. The location shown is based on the excavated trench. The alarm panel was not wired at the time of inspection. The Contractor is responsible for ensuring the panel is wired and the pump and alarm controls are wired on separate circuits.

**The elevated sand mound must be covered with filter fabric and topsoil and must be graded to allow surface water to run off. The mound must be seeded with grass to help facilitate evaporation and proper system functioning. It must be protected from traffic and parking.**

If you have any questions, please contact me.

Sincerely,

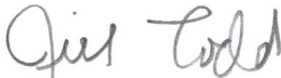

Jill Todd, M.S., R.S.

RECEIVED

JUL - 5 2018

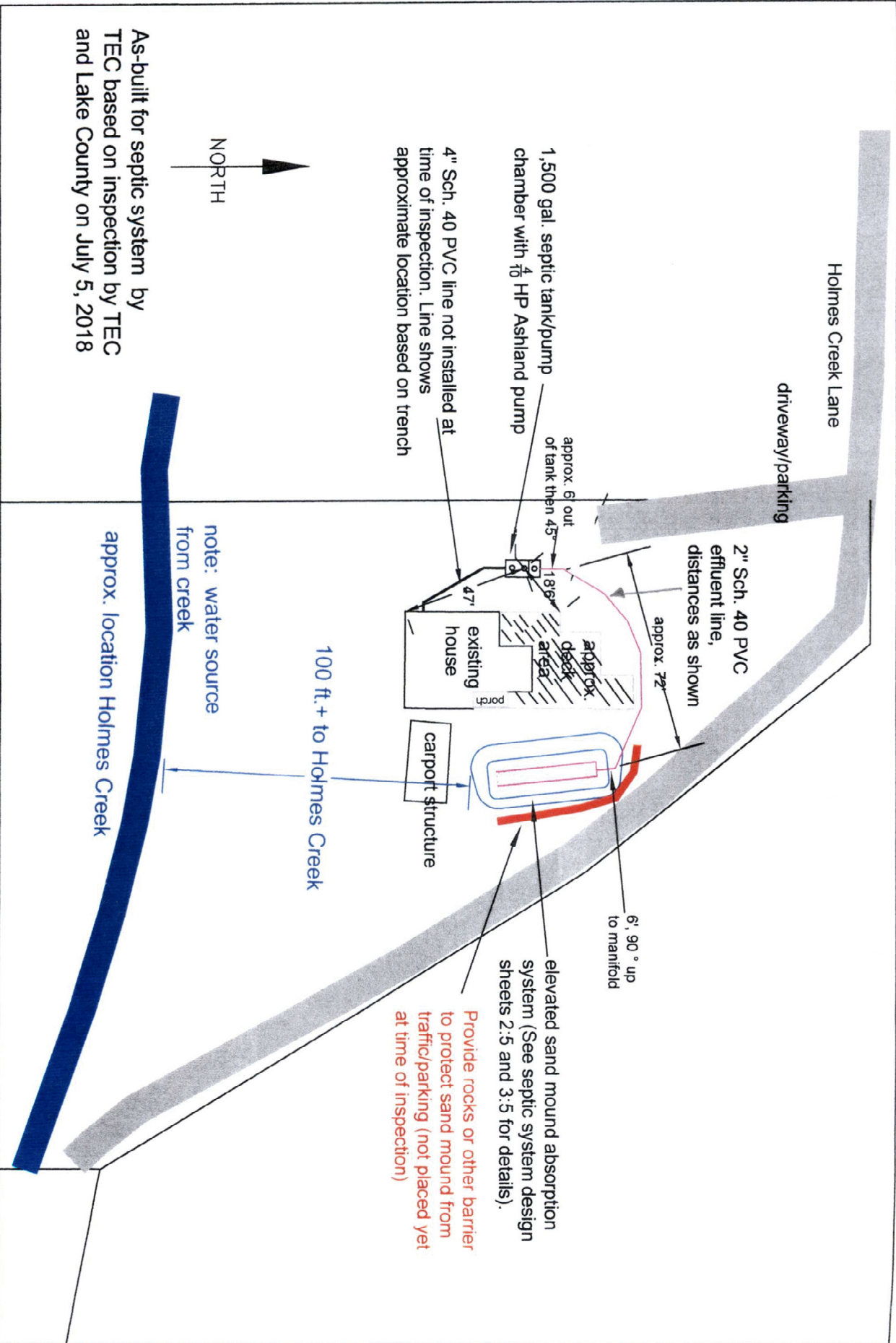

<p><b>Todd Environmental Consulting, LLC</b>          Please refer to septic system design sheets for detailed system specifications</p>		<p>As-Built Date: 7-5-18</p>		<p>As-Built for Septic System: 31611 Holmes Creek Lane: Lot 4 Osher Tracts</p>		<p>Owner: John Harley and Lisa Parks</p>		<p>SHEET</p>	
				<p>SCALE 1" = 50 ft.</p>				<p>REV</p>	
								<p>1:5</p>	