

LA COUNTY BOARD OF HEALTH

FINAL INSPECTION AND USE PERMIT OF INDIVIDUAL SEWAGE DISPOSAL SYSTEM

PROPERTY OWNER MAUNIE MOORE

PHYSICAL ADDRESS \_\_\_\_\_

LEGAL DESCRIPTION 1/4 1/4 Section 30, Twn 25 N, Rng 20 W

Parcel B on COS 3942

Permit No. 2256 Contractor SELF

INSPECTION SKETCH

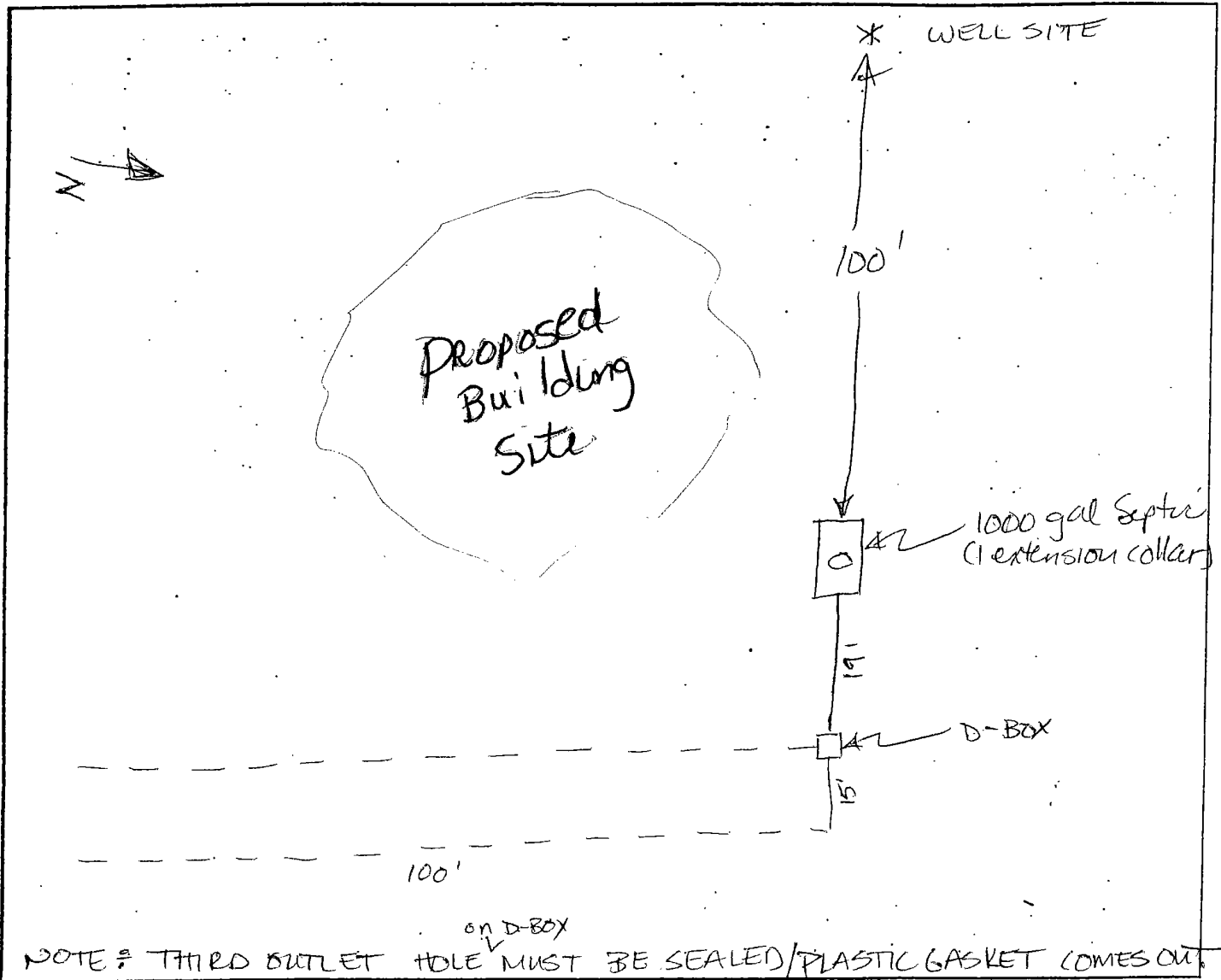

Is system installed according to approved pre-sketch? Yes  No

Inspected by Rebecca Dupuis Date 8/25/92

Signature of Applicant or Authorized Agent \_\_\_\_\_

FOR OFFICE USE ONLY: Computer  Blue Book

APPLICATION FOR LAKE COUNTY INDIVIDUAL  
SEWER DISPOSAL SYSTEM INSTALLATION PERMIT

Property owner MANNIE MOORE  
Legal Description Parcel B COS 3942 30-25-20  
General Description 1/4 mi. S. of DACY'S STORE Rollins  
Address P.O. Box 95 Rollins Phone No. \_\_\_\_\_  
Size of Parcel 18.2 AC tract  
Application is for \_\_\_\_\_ replacement 2 new sewage disposal system.  
Proposed dwelling 2Br  
Are any land use regulations in effect? Yes \_\_\_\_\_ No. X  
Does proposed dwelling conform to land use requirements? Yes X No. \_\_\_\_\_  
Contractor be S. License No. \_\_\_\_\_

PROPOSED SYSTEM

Proposed or existing water supply drilled well  
Size of proposed septic tank 1000 gal. concrete septic tank  
Soil type in area of proposed drainfield GRAVEL SANDY LOAM  
Percolation test results \_\_\_\_\_  
Absorption area proposed \_\_\_\_\_  
Type of absorption area proposed Dist Box AND 2 - 80' LATERALS +  
with 12" of gravel below drain tile

Pre-sketch of proposed system layout - (use back of application; show property lines distance to wells, streams, irrigation ditches, lake, etc. percent and direction of slope).

I hereby declare that the information submitted herein is true and complete to the best of my knowledge. I understand that a final inspection of the approved system must be conducted by the Lake County Health Department.

Mannie A. Moore 3/12/92  
Applicant or Authorized Agent Date

X Approved \_\_\_\_\_ Disapproved Permit No. 2256

Al Hershfield  
Health Officer or Supervising Sanitarian  
883-6211

\* Approved permit invalid if system is not installed within six (6) months of issuance.



371-300